

4 Tier Cascading Water Feature Instruction Manual



After Sales Support
Call 0871 911 7031
Email
customerservice@gardengearonline.co.uk
Product Code: G4644

Thank you for purchasing this product, which has been made to high quality standards and is guaranteed for domestic use against manufacturing faults for a period of 12 months from date of purchase

For correct usage, please read these instructions carefully before first use and store in a safe place for future reference.

Safety warnings and general information

- Use this product only in accordance with the instructions.
- Children should be supervised to ensure that they do not play with product.
- This product is not a toy.
- Keep the product and its power cable out of reach of children.
- Before cleaning and when not in use unplug from the mains supply.
- Do not handle the electrical components with wet hands.
- Do not use the appliance with a damaged power cord or plug.
- To avoid hazards, ensure that any electric cable is safely out of the way of children and pets.
- Where possible ensure all power cables are positioned away from footfall areas.
- It is important that an RCD (Residual Current Device) is present, and any product of this type is connected to it.
- When removing re-positioning or replacing the water pump make sure the power is off and the plug is out of the socket.
- Repairs to electrical equipment should only be performed by a qualified electrician. Improper repairs may place user at serious risk.
- Always use the original power cable supplied with the product.
- Make sure the voltage on the rating label matches the mains power supply to be used.
- Do not unplug by pulling the power cable.
- Water temperature must not exceed 35°C. Top the water levels up frequently during hot weather.
- In very low temperatures, drain, dry and protect the water feature from frost, snow and ice.
- This product is designed for outdoor use only and should not be positioned where water spillage may damage carpets or furnishings.
- Always position on a flat level surface.
- The chosen location should be free from overhanging trees and bushes which may shed their leaves in autumn.
- Ensure that the water level is always sufficient; do not allow the pump to run dry.
- To eliminate the possibility of water damage around your water feature, check for leaks and excessive splashing after the initial setup.
- Do not leave your water feature running for extended periods of time unattended.
- Occasionally the water pump may make excessive noise, this may be due to the pump rattling against the side of the reservoir or a small amount of trapped air. Always ensure that the pump is suckered to the base using the rubber feet. Remove any trapped air by gently shaking the water pump.
- This water feature is not suitable for commercial purposes.

Locating the water feature

- Position the base on a suitable firm, level surface away from areas where it is likely to become clogged with leaves or debris, which could damage the pump.
- Unpack the components and lay out on a flat surface.
- Check there is enough cable to reach the plug socket.
- Ensure the feature is only placed on surfaces that will not get marked or damaged by water splashing. If placing on wooden decking, ensure that the base surface has been sealed or treated as appropriate. Place in a location where any water spills or splashing will not reach any other electrical equipment or cause damage.

Assembly



Reach inside the opening in the rear or side of the water feature, pulling out the tubing/water pipe and internal LED cable(s), (if the water feature is supplied with lights – not available on all models)

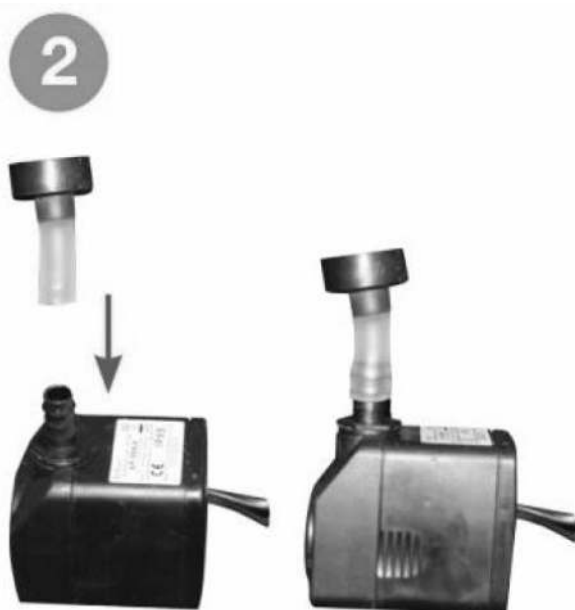

Connect the tubing to the outlet of the pump and place it in the water reservoir through the opening in the rear or top of the water feature; secure to the base of the reservoir using the suckers to prevent the pump from moving around

3



If your water feature is supplied with lights, connect the two ends of the LED lighting wires together and screw over the plastic collar. Push the cable with two pins into the transformer and screw over the plastic collar

4



Place the pump and excess wires into the access cavity, ensuring that the long pump and LED wires extend out through the opening

5



Carefully fill the fountain with sufficient clean, cold tap water ensuring the pump is fully submerged

6



Connect the plug from the transformer to your mains outlet

Adjusting the flow of the water

The flow of the water can be adjusted by turning the dial on the water pump.



Water flow adjuster

Care and maintenance

- Keep water clean and free from debris. If debris gets caught in the pump, disconnect it from any power sources and rinse the pump under clean running water.
- Clean the water feature periodically to prevent build-up of mineral deposits on the sides and base. Use a stiff brush and clean warm water with a little liquid soap. Do not use detergents or abrasives as this will damage the surface of your water feature.
- Frost can cause damage to the pump. The pump must be removed and stored in a frost-free environment if the water is likely to freeze.

GUARANTEE

IMPORTANT

**Please do not return this product without first calling the Customer Service number below:
0871 911 7031***

Thank you for purchasing this product, which has been made to demanding high quality standards and is guaranteed for domestic use against manufacturing faults for a period of 12 months from the date of purchase.

This guarantee does not affect your statutory rights. If your product fails due to a defect in material or workmanship during this period, please return it to the place of purchase. Normal wear and tear is not covered under the guarantee.

Any guarantee is invalid if the product has been misused or subject to neglect or an attempted repair other than by our own service centre.

Due to continuous product improvement, we reserve the right to change the product specification without prior notice.

After Sales Customer Service:

Customer Service Department, Branded Garden Products Ltd, Premier House, Hortonwood 7, Telford, TF1 7GP, UK

Telephone: 0871 911 7031*

E-mail customerservice@gardengearonline.co.uk

Please retain for future reference.

Colours and contents may vary.

Waste electrical products should not be disposed of with household waste. Please recycle where facilities exist. Check with your Local Authority or retailer for recycling advice.

Please note that all products with the symbol below must be recycled.



*Calls cost 13p per minute, plus your phone company's access charge